

品番構成法/Type descriptions

MH

型式
Model

S

素子
Element

10

定格電力
Rated power

N

取付金具
Mounting
metal fitting

1 0 0

公称抵抗値
Nominal Resistance

J

抵抗値許容差
Tolerance for
resistance

I

仕様規格
Standard spec.

S - 巻線(ガラス繊維芯)
Wire-wound-type
(glass fiber core)
R - 酸化金属皮膜
Metal oxide film

10 - 10 W
15 - 15 W
20 - 20 W
25 - 25 W
30 - 30 W
40 - 40 W

N - なし
Nil
A - 横型
Horizontal
B - 縦型
Vertical

初めの2桁は有効数字、
3桁目はそれに続くゼロの数、小数点はRで示す。
The first two digits are For an effective value
and The third digit denotes
The number of zeros following the former.
The decimal point is indicated by "R"
[例] Example
0.5 = R50
100 = 101
2k = 202

J - ± 5%

I - 一般品
General
N - 無誘導
Non-inductive

MHS

MHR

シャーシ固定放熱(促進)タイプ抵抗器 Chassis-fixed radiant (efficient) heat types

取付金具 N

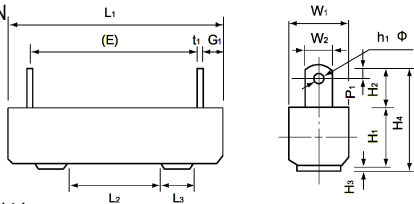

定格電力、寸法
Rated power, Dimensions,

定格電力 Rated power (W)	寸法 (mm) Dimensions (mm)													抵抗値範囲 () Resistance range		
	L1	L2	L3	W1	W2	H1	H2	H3	H4	P1	(E)	G1	t1	h1	MHS	MHR
10	48.0 ± 1.5	25 ± 1.0	4.5	9.5 ± 1.0	5.0	9.5 ± 1.0	6.0 ± 1.5	0.8	16.5 ^{+1.5} _{-1.0}	2.5	36.0	5.5 ⁺² ₋₁	0.4	2.0	1.0 ~ 1.5K	200 ~ 150K
15	48.0 ± 1.5	25 ± 1.0	7.0	12.5 ± 1.2	6.0	12.5 ± 1.2	7.5 ± 2.0	1.0	21.0 ^{+2.0} _{-1.0}	3.0	34.0	6.5 ⁺² ₋₁	0.5	2.5	1.0 ~ 2.0K	510 ~ 200K
20	63.5 ± 2.0	25 ± 1.0	7.0	12.5 ± 1.2	6.0	12.5 ± 1.2	7.5 ± 2.0	1.0	21.0 ^{+2.0} _{-1.0}	3.0	49.5	6.5 ⁺² ₋₁	0.5	2.5	1.0 ~ 3.0K	510 ~ 240K
25	63.5 ± 2.0	25 ± 1.0	8.0	16.0 ± 1.2	7.5	16.0 ± 1.2	12.0 ± 2	1.0	29.0 ^{+2.5} _{-1.5}	3.5	46.5	8.0 ^{+2.5} ₋₁	0.5	3.0	1.2 ~ 3.6K	
30	75.0 ± 2.5	40 ± 1.2	10	19.0 ± 1.5	7.5	19.0 ± 1.5	10.0 ± 2	1.0	30.0 ^{+2.5} _{-1.5}	3.5	56.0	9.0 ⁺³ ₋₁	0.5	3.0	1.5 ~ 4.3K	
40	90.0 ± 2.5	40 ± 1.2	10	19.0 ± 1.5	7.5	19.0 ± 1.5	10.0 ± 2	1.0	30.0 ^{+2.5} _{-1.5}	3.5	71.0	9.0 ⁺³ ₋₁	0.5	3.0	1.8 ~ 5.6K	

取付金具 A

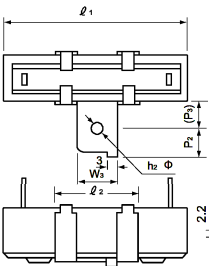

取付金具 B

10W, 20W, 25W, 40W

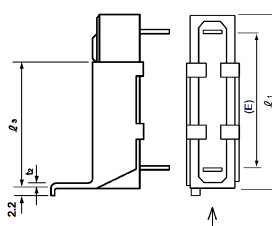

15W, 30W

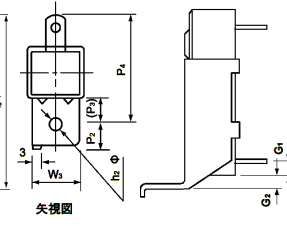

軽減曲線

Derating curve

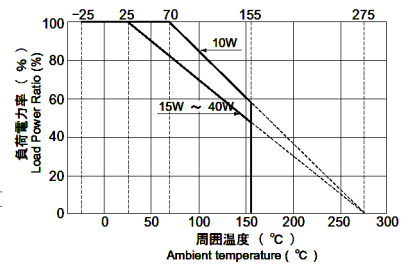

定格電力、金具付き寸法、抵抗値範囲、他
Rated power, Dimensions with metal fittings, Resistance range, etc.

定格電力 Rated power (W)		寸法 (mm) Dimensions (mm)										RoHS	
		l1	l2	l3	W3	P2	(P3)	P4	G1	G2	t2		h2
10	A	48.0 ± 1.5	24		12 ± 0.2	6	8	24.5 ⁺² ₋₁	5.5 ⁺² ₋₁		0.6	4.0	
	B	48.0 ± 1.5	36		12 ± 0.2	6	8	24.5 ⁺² ₋₁	5.5 ⁺² ₋₁		0.6	4.0	
15	A	48.0 ± 1.5	24		12 ± 0.2	6	8	28.0 ^{+2.5} ₋₁	6.5 ⁺² ₋₁		0.8	4.0	
	B	56.0 ± 2.0	43		12 ± 0.2	6	8	28.0 ^{+2.5} ₋₁	6.5 ⁺² ₋₁	8.0 ± 2	0.6	4.0	
20	A	63.5 ± 2.0	24		12 ± 0.2	6	8	28.0 ^{+2.5} ₋₁	6.5 ⁺² ₋₁		0.8	4.0	
	B	63.5 ± 2.0	43		12 ± 0.2	6	8	28.0 ^{+2.5} ₋₁	6.5 ⁺² ₋₁		0.6	4.0	
25	A	63.5 ± 2.0	24		12 ± 0.2	6	10	38.0 ⁺³ _{-1.5}	8.0 ^{+2.5} ₋₁		0.8	4.2	
	B	63.5 ± 2.0	43		12 ± 0.2	6	10	38.0 ⁺³ _{-1.5}	8.0 ^{+2.5} ₋₁		0.8	4.2	
30	A	75.0 ± 2.5	39		18 ± 0.2	8	10	39.0 ⁺³ _{-1.5}	9.0 ⁺³ ₋₁		0.8	4.2	
	B	82.5 ± 2.5	64		18 ± 0.2	8	10	39.0 ⁺³ _{-1.5}	9.0 ⁺³ ₋₁	7.5 ± 2	0.8	4.2	
40	A	90.0 ± 2.5	39		18 ± 0.2	8	10	39.0 ⁺³ _{-1.5}	9.0 ⁺³ ₋₁		0.8	4.2	
	B	90.0 ± 2.5	64		18 ± 0.2	8	10	39.0 ⁺³ _{-1.5}	9.0 ⁺³ ₋₁		0.8	4.2	

温度上昇(参考)

Temperature rise(ref.)

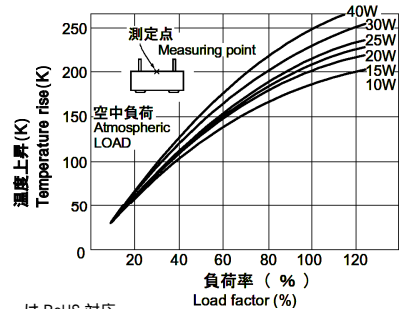

注1) は RoHS 対応。
NB.1) : RoHS Compliant.